

MAGNUM SR SERIES

PARTS MANUAL



MAGNUM 300SR
MAGNUM 420SR
MAGNUM 480SR

Bucyrus Equipment Co., Inc.
Box 156, 209 Main
Hillsdale, Ks 66036
1-800-330-0857
www.magnumharvesters.com

RE-ORDER NUMBER: SRMANUAL
REVISION: SR-100020



SR SERIES

MAGNUM 300SR/420SR/480SR PARTS MANUAL

The purpose of this manual is for parts identification of the Magnum SR series harvester. This manual is not to be used for assembly. This manual includes parts lists and illustrations of all available replacement parts for the Magnum SR series harvesters. A table of contents is placed at the beginning of the manual for location of specific parts. Keep this manual available for reference in the shop area.

At the time of publication all information contained in this manual was technically correct. However, all materials and specifications are subject to change without notice.

Comments and suggestions about this manual may be directed to: Bucyrus Equipment Co., Inc., PO Box 156-209 Main, Hillsdale, KS 66036. Phone 1-800-330-0857

©Copyright 2005 BECI. All information contained within this publication is based on the latest product information at the time of publication. Due to constant improvements in the design and quality of production components, some minor discrepancies may result between the actual vehicle and the information presented in this publication. Depictions and/or procedures in this publication are intended for reference use only. No liability can be accepted for omissions or inaccuracies. Any reprinting or reuse of the depictions and/or procedures contained within, whether whole or in part, is expressly prohibited. Printed in U.S.A.

TABLE OF CONTENTS

Section 1	420/480 Floating Heads
Section 2	420/480 Solid Heads/Coulter Option
Section 3	300 Solid Heads/Coulter Option
Section 4	Depth Control
Section 5	1 st Conveyor
Section 6	2 nd Conveyor
Section 7	Chop Offs
Section 8	Net Dispenser
Section 9	Ramps
Section 10	Tube Racks
Section 11	Control Panel Box
Section 12	Wheel/Hub Assembly
Section 13	Hydraulic Components
Section 14	Valve Body
Section 15	Flow Control Valve

Section 16 Chop Valve

Section 17 Accumulator

Section 18 Hydraulic Tank/Increaser

Section 19 Hose/Hardline Mounts

Section 20 Electrical Components

WHEEL/HUB ASSEMBLY

Parts List			
ITEM	QTY	PART NUMBER	DESCRIPTION
1	2	33X15.50-16.5	Tire
2	2	DU008	Dust cap
3	2	DU007	Spindle nut
4	2	DU006	Washer
5	2	DU003	Outer bearing
6	1	DU004-LH (Left side) DU004-RH (right side)	Hub
7	2	DU005	Inner bearing
8	2	DU002	Seal
9	7	10012	Magnet & rivet
10	1	RW3000-HD	Magnet plate assy.
11	2	W888A-480	Spindle
12	16	58LUG	5/8"lug bolt
13	2	65078	1/8" X 1.5" COTTER PIN
14	2	16.5X12 DC WHEELS	Rim



WHEEL/HUB ASSEMBLY

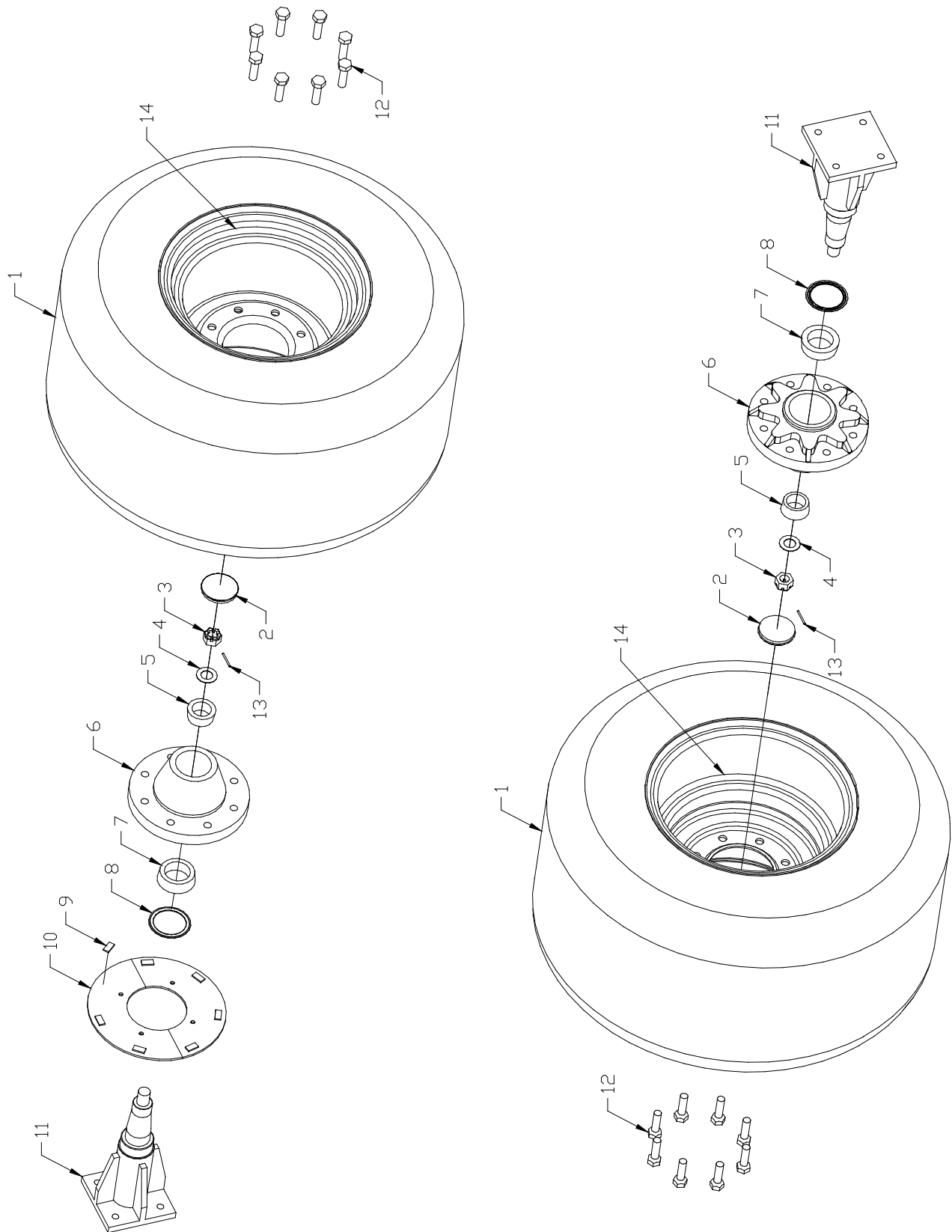

WHEEL/HUB ASSEMBLY

This image shows a single sheet of white paper with horizontal blue or grey ruling lines. The lines are evenly spaced and run across the width of the page. There are no margins, text, or other markings on the paper.