

MAGNUM AUTO STAKER

PARTS MANUAL

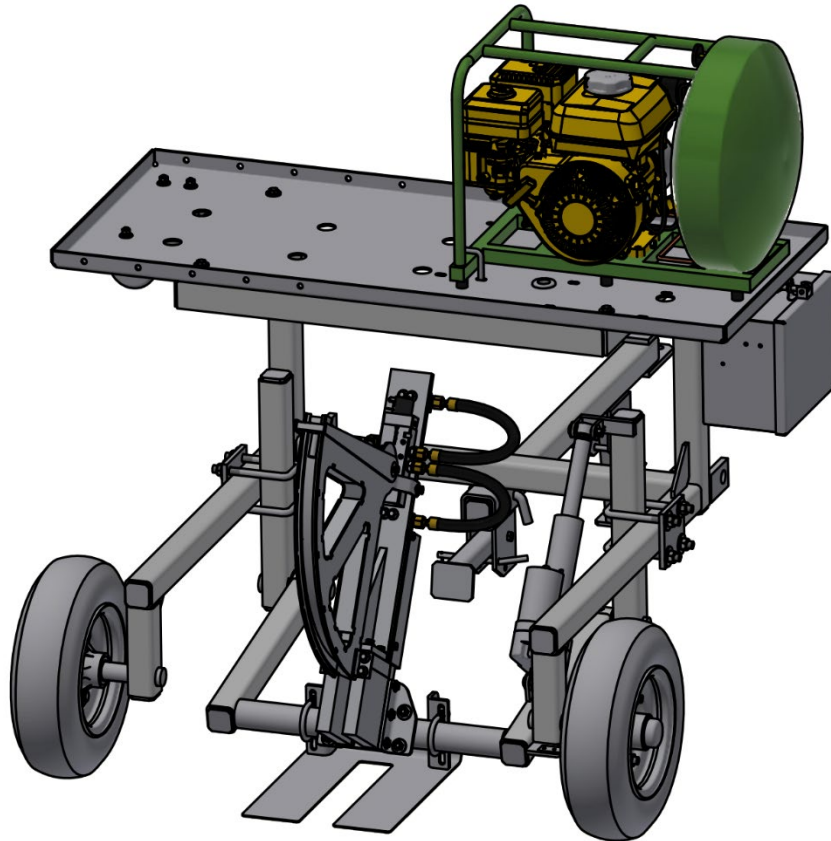

MAGNUM SAS300/DAS300

Bucyrus Equipment Co., Inc.
Box 156, 209 Main
Hillsdale, Ks 66036
1-800-330-0857
www.magnumenp.com

RE-ORDER NUMBER: SAS-300 MANUAL
REVISION: SAS-000000



MAGNUM SAS300/DAS300 PARTS MANUAL

The purpose of this manual is for parts identification of the Magnum SAS300/DAS300 Auto Staker. This manual is not to be used for assembly. This manual includes parts lists and illustrations of all available replacement parts for the Magnum Field Auto Staker. A table of contents is placed at the beginning of the manual for location of specific parts. Keep this manual available for reference in the shop area.

At the time of publication all information contained in this manual was technically correct. However, all materials and specifications are subject to change without notice.

Comments and suggestions about this manual may be directed to: Bucyrus Equipment Co., Inc., PO Box 156-209 Main, Hillsdale, KS 66036. Phone 1-800-330-0857

© Copyright 2013 BECI. All information contained within this publication is based on the latest product information at the time of publication. Due to constant improvements in the design and quality of production components, some minor discrepancies may result between the actual vehicle and the information presented in this publication. Depictions and/or procedures in this publication are intended for reference use only. No liability can be accepted for omissions or inaccuracies. Any reprinting or reuse of the depictions and/or procedures contained within, whether whole or in part, is expressly prohibited. Printed in U.S.A.

TABLE OF CONTENTS

Section 1	Parts
Section 2	Electrical
Section 3	Pneumatics
Section 4	Staker
Section 5	Dual Staker
Section 6	Decals

Pneumatics Section - Parts List

ITEM	QTY	PART NUMBER	DESCRIPTION
1	1	ST-PN900	PNEUMATIC HOSE KIT
2	1	BN-STK900	STAKE ASSEMBLY
3	2	6500-06-06	PNEUMATIC FITTING
4	1	2402-06-04	PNEUMATIC FITTING
5	1	DCP20	PNEUMATIC FITTING
6	1	6536K280	PNEUMATIC FITTING
7	1	3400-04-04	PNEUMATIC FITTING



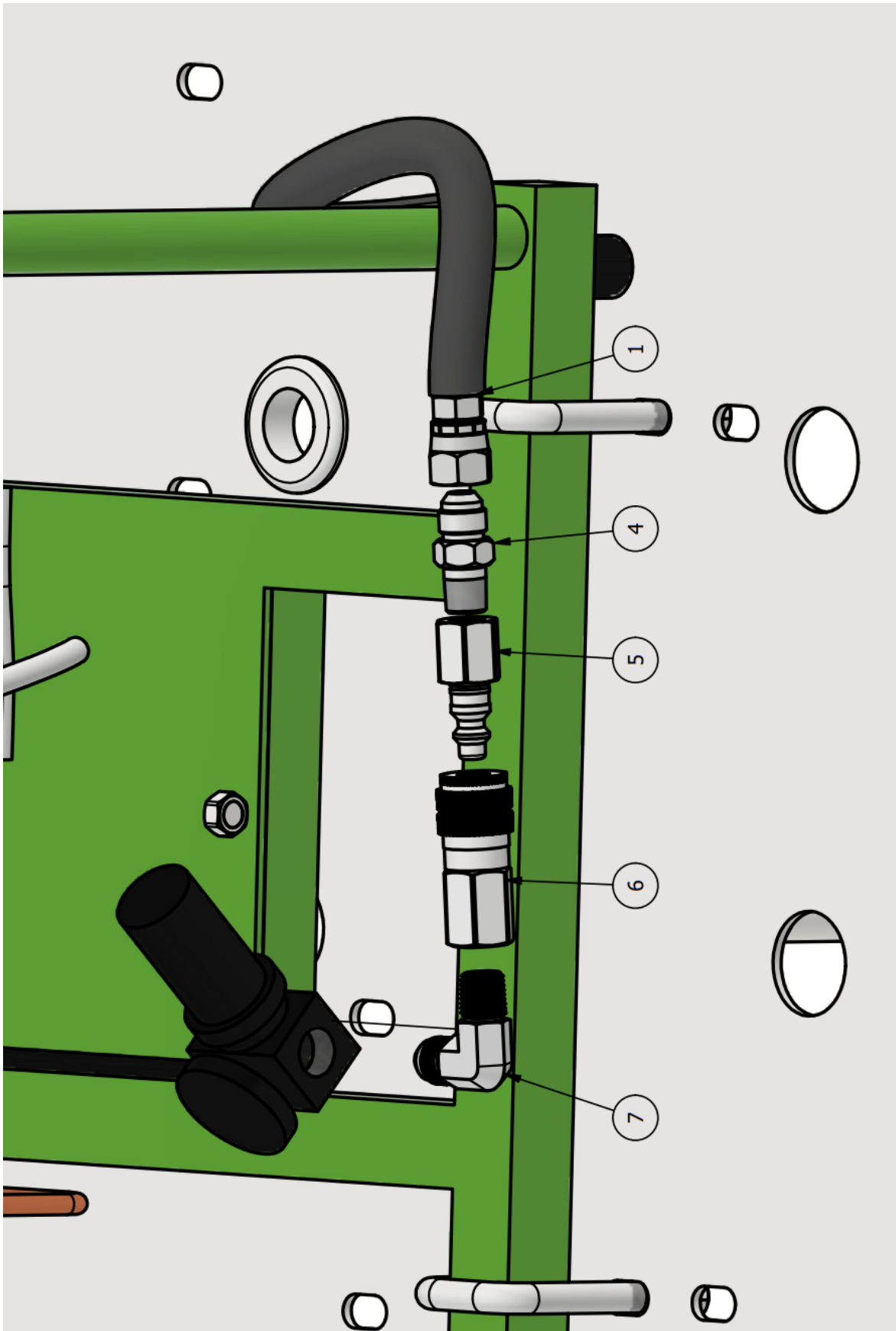

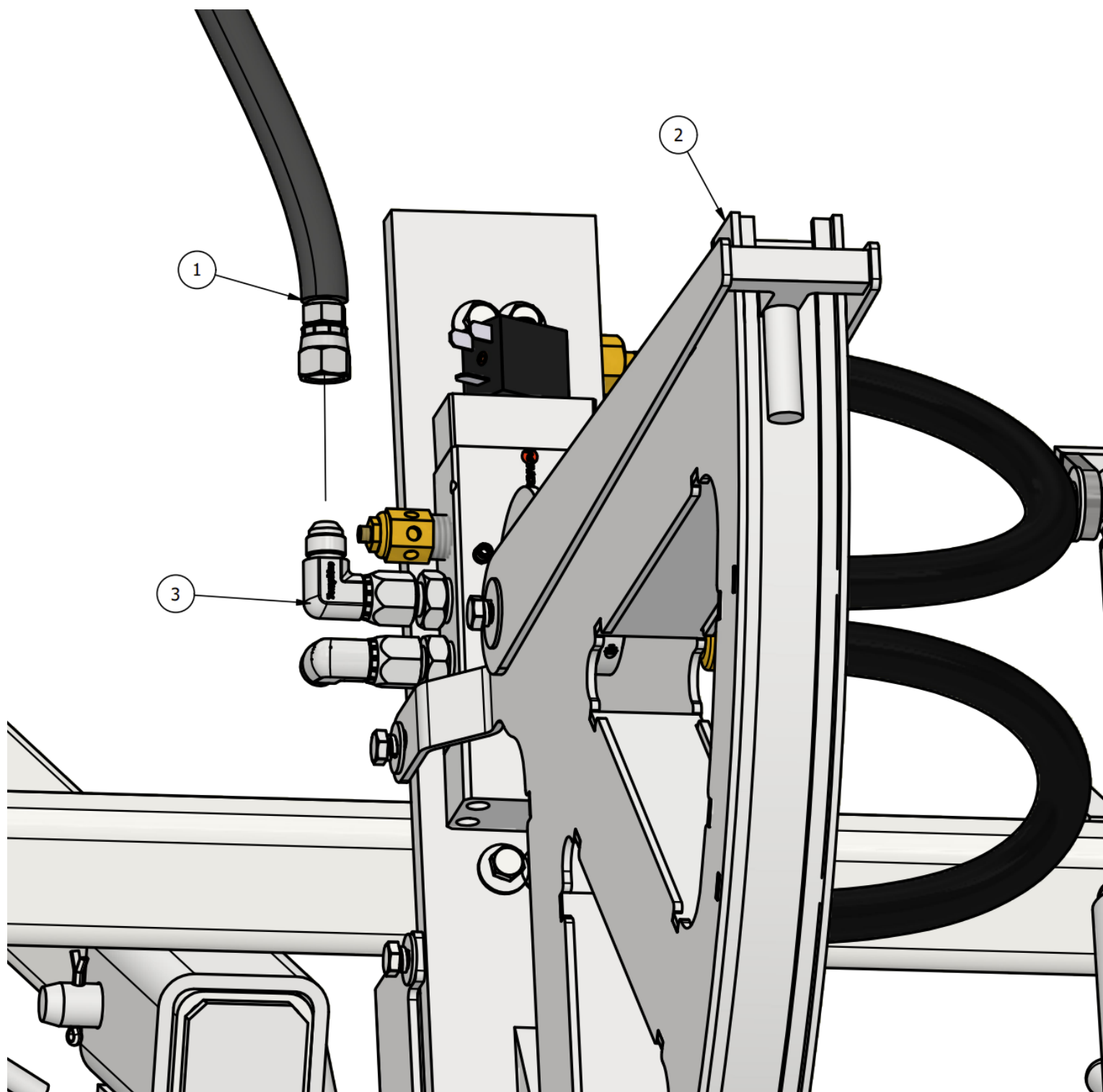

[illegible]