

MAGNUM A SERIES DIESEL SOD INSTALLER PARTS MANUAL



**MAGNUM A42D
MAGNUM A48D**

Bucyrus Equipment Co., Inc.
Box 156, 209 Main
Hillsdale, Ks 66036
1-800-330-0857
www.magnumenp.com

RE-ORDER NUMBER: 2IND-MANUAL
REVISION: 2IND-100010



A SERIES

MAGNUM A42D / A48D PARTS MANUAL

The purpose of this manual is for parts identification of the Magnum A series sod installer. This manual is not to be used for assembly. This manual includes parts lists and illustrations of all available replacement parts for the Magnum A series sod installer. A table of contents is placed at the beginning of the manual for location of specific parts. Keep this manual available for reference in the shop area.

At the time of publication all information contained in this manual was technically correct. However, all materials and specifications are subject to change without notice.

Comments and suggestions about this manual may be directed to: Bucyrus Equipment Co., Inc., PO Box 156-209 Main, Hillsdale, KS 66036. Phone 1-800-330-0857

© Copyright 2013 BECI. All information contained within this publication is based on the latest product information at the time of publication. Due to constant improvements in the design and quality of production components, some minor discrepancies may result between the actual vehicle and the information presented in this publication. Depictions and/or procedures in this publication are intended for reference use only. No liability can be accepted for omissions or inaccuracies. Any reprinting or reuse of the depictions and/or procedures contained within, whether whole or in part, is expressly prohibited. Printed in U.S.A.

RE-ORDER NUMBER: 2IND-MANUAL
REVISION: 2IND-100010

TABLE OF CONTENTS

Section 1	BRAKE, WHEEL, & HUB
Section 2	DECALS
Section 3	ELECTRICAL
Section 4	ENGINE
Section 5	FRONT SPENDLE
Section 6	HYDRALICS
Section 7	HYDROSTAT ROLL LIFT CONTROL
Section 8	OPERATORS PLATFORM
Section 9	ROLL LIFT
Section 10	SHIELDS
Section 11	STEERING AXLE

**MAG A42D & A48
FORK LIFT**

**FORK LIFT – VERSION 1
SERIAL NUMBER ENDING IN 230 TO 281**

ITEM	QTY	PART NUMBER	DESCRIPTION
1	4	64UBOLT	U BOLT
2	2	2IND-FRK102	FORKLIFT ROLL LIFT MNT
3	2	97141A590	CLEVIS PIN TOGGLE, 3/8" DIA X 4" LG
4	2	2IND-FRK101	FORK LIFT MNT PLT
5	1	2IND-FRK100	FORK CARRIAGE
6	4	3SQUBOLT	3" SQUARE U-BOLT
7	1	FRK100	FORKS (1 PAIR)
8	8	33895	1/2" LOCK WASHER
9	8	33817	1/2" SAE WASHER
10	8	36310	1/2"-13 HEX NUT
11	12	36314	5/8"-11 HEX NUT
12	12	33897	5/8" LOCK WASHER
13	8	33819	5/8" SAE WASHER
14	4	24410	5/8"-11 X 3 1/2" FLATHEAD SOCKET SCREW



MAG A42D & A48
FORK LIFT

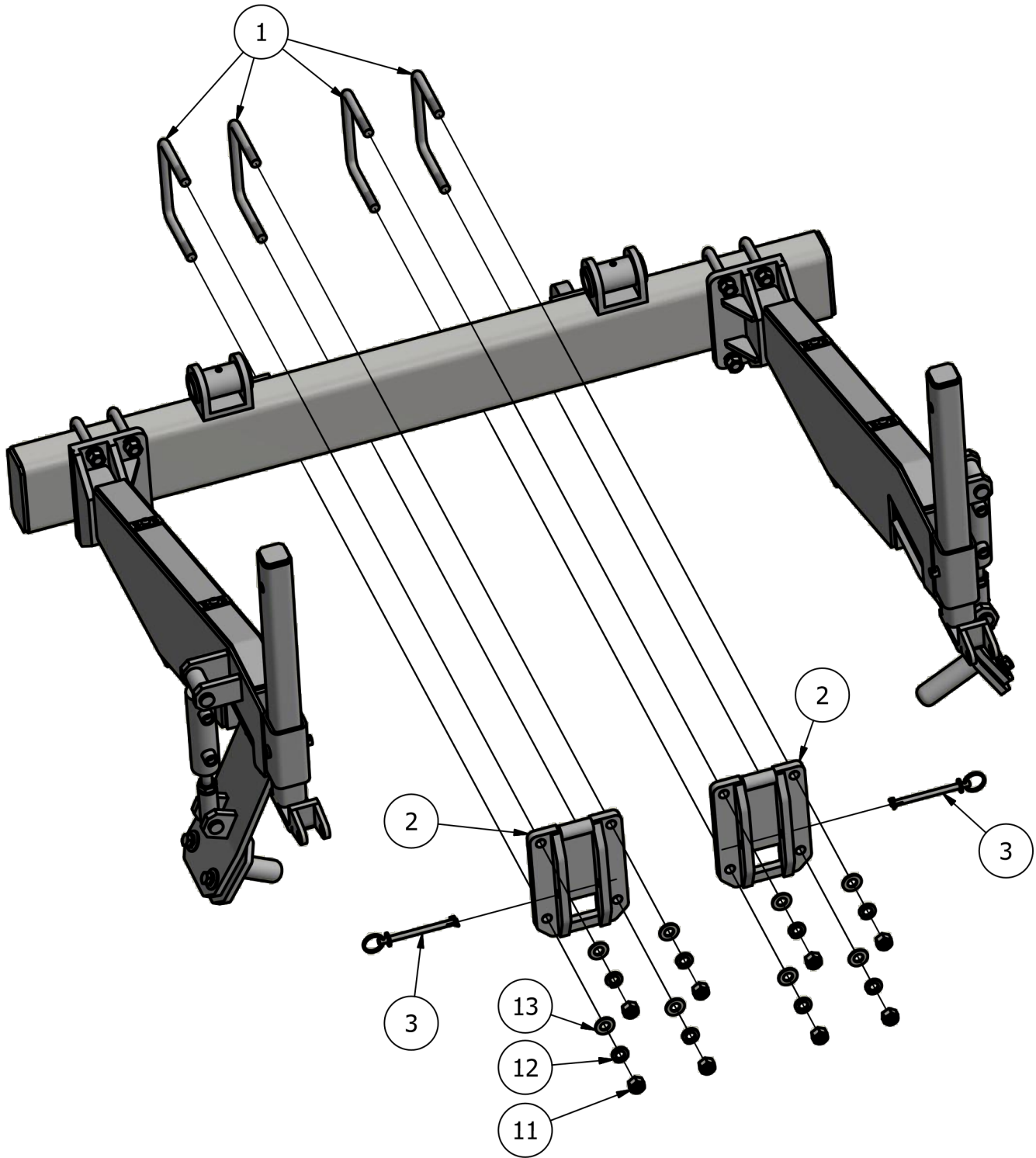

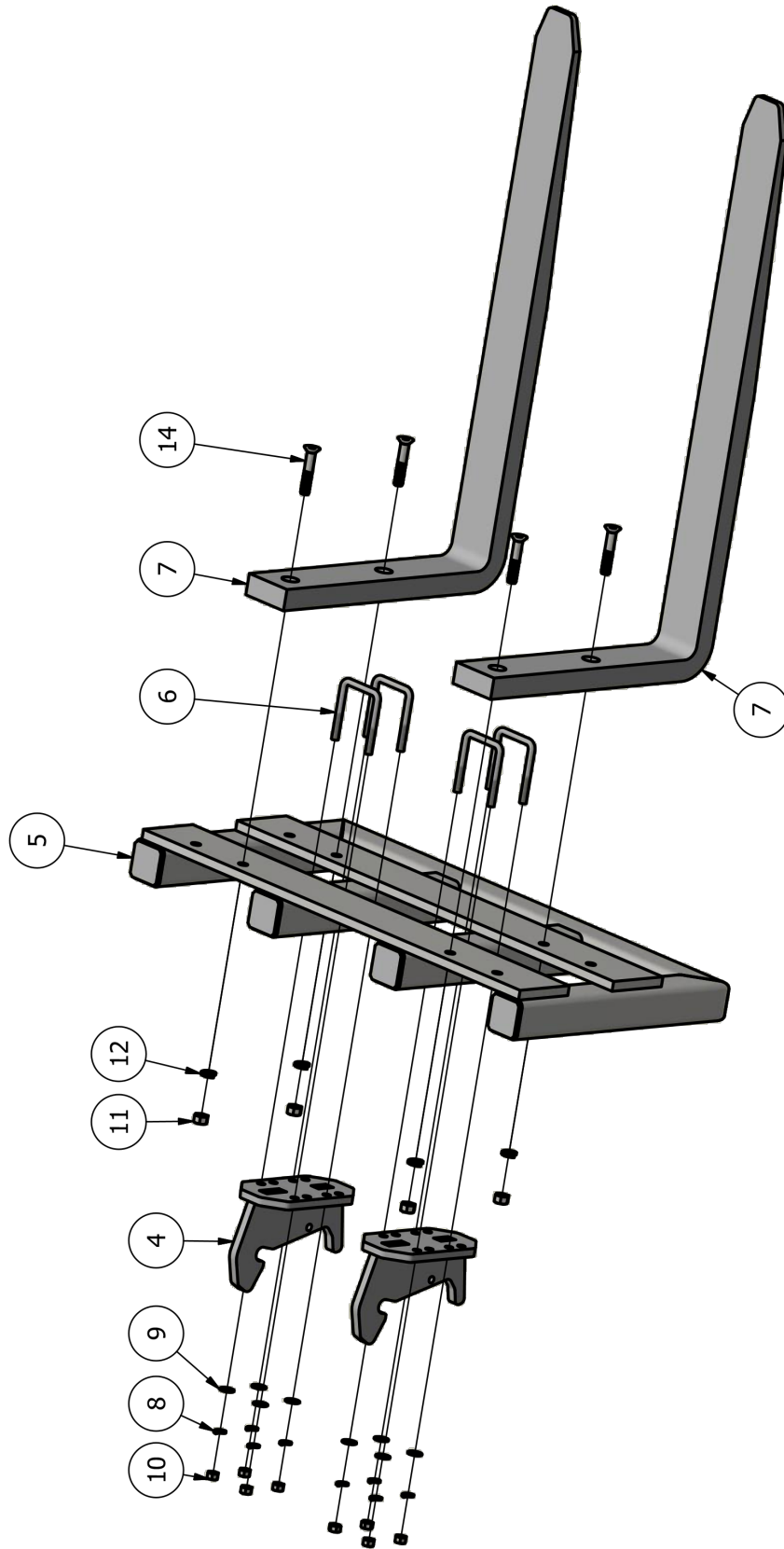

FORK LIFT – VERSION 2

SERIAL NUMBER ENDING IN 282 TO CURRENT

ITEM	QTY	PART NUMBER	DESCRIPTION
1	4	64UBOLT	U BOLT
2	2	98497A664	CLEVIS PIN TOGGLE, 3/8" DIA X 4" LG
3	2	2IND-FRK104	FORKLIFT ROLL LIFT MNT
4	2	2IND-FRK103	FORK LIFT MNT PLT
5	1	2IND-FRK100	FORK CARRIAGE
6	4	3SQUBOLT	3" SQUARE U-BOLT
7	1	FRK100	FORKS (1 PAIR)
8	8	33817	1/2" SAE WASHER
9	8	33895	1/2" LOCK WASHER
10	8	36310	1/2"-13 HEX NUT
11	8	33819	5/8" SAE WASHER
12	4	24410	5/8"-11 X 3 1/2" FLATHEAD SOCKET SCREW
13	12	33897	5/8" LOCK WASHER
14	12	36314	5/8"-11 HEX NUT



MAG A42D & A48
FORK LIFT

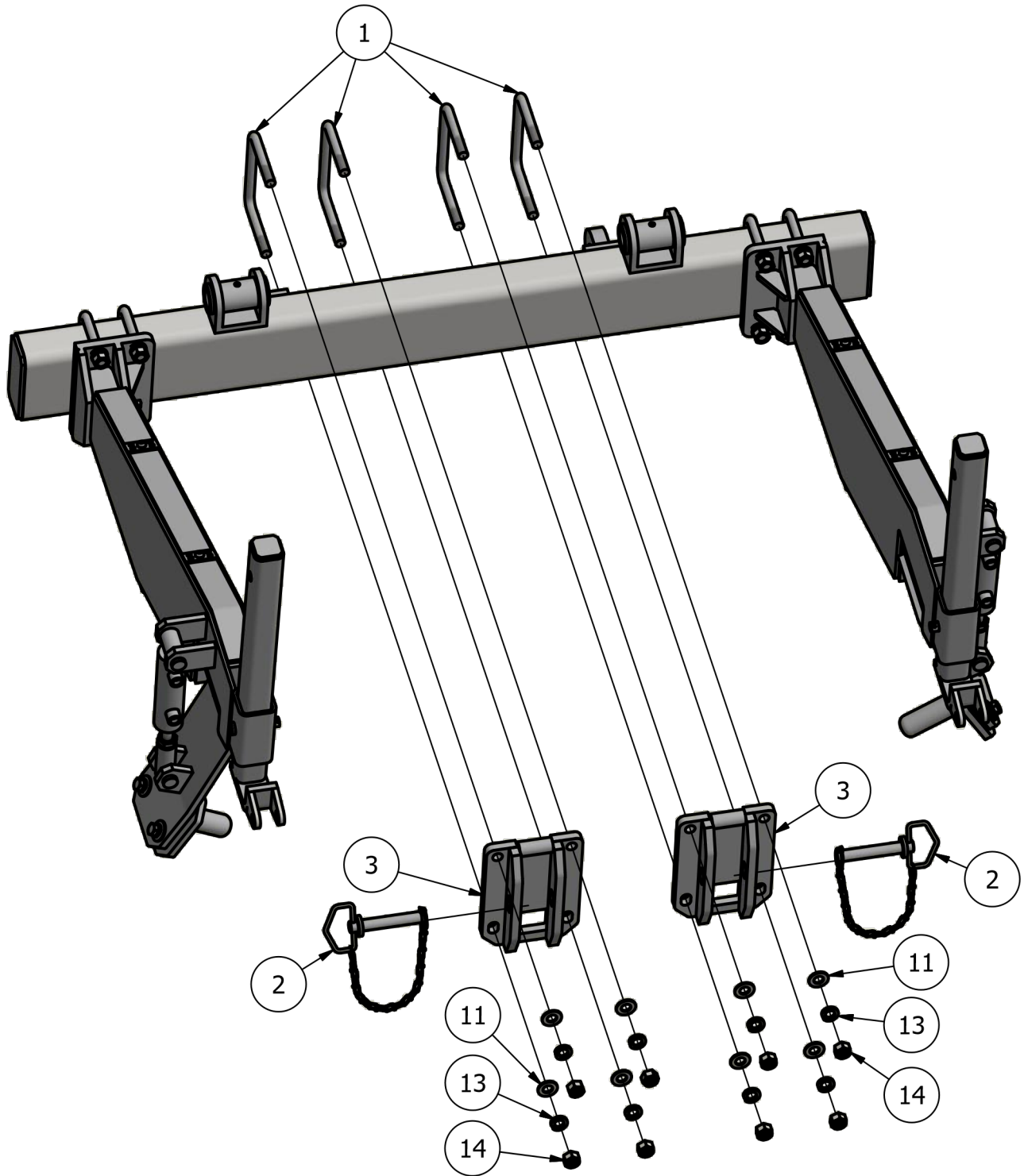

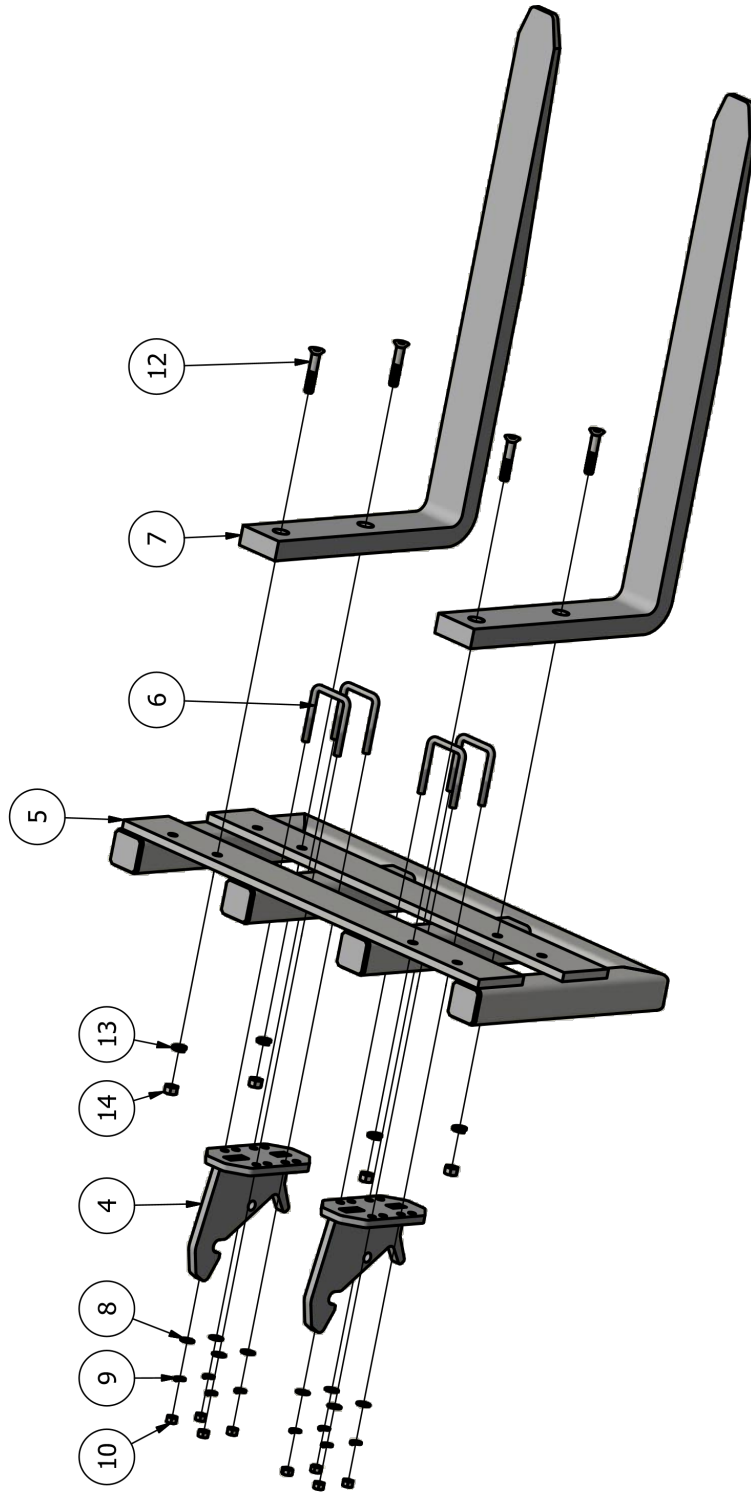

NOTES:

This image shows a full page of white paper with horizontal blue ruling lines. The lines are evenly spaced and run across the width of the page, providing a template for handwriting practice or general writing. There are no margins, text, or other markings on the page.