

MAGNUM M SERIES DIESEL SOD INSTALLER PARTS MANUAL



**MAGNUM M4226D
MAGNUM M4826D**

Bucyrus Equipment Co., Inc.
Box 156, 209 Main
Hillsdale, Ks 66036
1-800-330-0857
www.magnumenp.com

RE-ORDER NUMBER: IND-MANUAL
REVISION: IN-100007



M SERIES

MAGNUM M4226D / M4826D PARTS MANUAL

The purpose of this manual is for parts identification of the Magnum M series sod installer. This manual is not to be used for assembly. This manual includes parts lists and illustrations of all available replacement parts for the Magnum M series sod installer. A table of contents is placed at the beginning of the manual for location of specific parts. Keep this manual available for reference in the shop area.

At the time of publication all information contained in this manual was technically correct. However, all materials and specifications are subject to change without notice.

Comments and suggestions about this manual may be directed to: Bucyrus Equipment Co., Inc., PO Box 156-209 Main, Hillsdale, KS 66036. Phone 1-800-330-0857

© Copyright 2013 BECI. All information contained within this publication is based on the latest product information at the time of publication. Due to constant improvements in the design and quality of production components, some minor discrepancies may result between the actual vehicle and the information presented in this publication. Depictions and/or procedures in this publication are intended for reference use only. No liability can be accepted for omissions or inaccuracies. Any reprinting or reuse of the depictions and/or procedures contained within, whether whole or in part, is expressly prohibited. Printed in U.S.A.

TABLE OF CONTENTS

| | |
|-------------------------|---------------------------------------|
| Section 1 | Brake / Wheel / Hub |
| Section 2 | Decals |
| Section 3 | Electrical |
| Section 4 | Engine |
| Section 5 | Front Spindle |
| Section 6 | Hydraulics |
| Section 7 | Hydrostat / Roll Lift Controls |
| Section 8 | Operator Platform |
| Section 9 | Roll Lift |
| Section 10 | Shields |
| Section 11 | Steering Axle |



DECALS

| DECALS - PARTS LIST | | | |
|---------------------|-----|--------------|--|
| ITEM | QTY | PART NUMBER | DESCRIPTION |
| 1 | 1 | IN-DCL101 | FORWARD/REVERSE - ARMS RAISE/LOWER DECAL |
| 2 | 1 | IN-DCL102 | WHEELS INBOARD DECAL |
| 3 | 1 | IN-DCL103 | 2X DECAL |
| 4 | 1 | IN-DCL104 | 4X DECAL |
| 5 | 1 | IN-DCL105 | FLUID LEVEL DECAL |
| 6 | 1 | IN-DCL107 | SYNTHETIC HYDRAULIC FLUID ONLY DECAL |
| 7 | 1 | IN-DCL109 | SAFETY INSTRUCTIONS DECAL |
| 8 | 2 | IN-DCL110 | READ OPERATORS MANUAL DECAL |
| 9 | 1 | IN-DCL111 | WARNING PLATFORM DECAL |
| 10 | 2 | IN-DCL113 | LOCK DECAL |
| 11 | 2 | IN-DCL114 | UNLOCK DECAL |
| 12 | 1 | IN-DCL115 | WHEEL LOCK DECAL |
| 13 | 1 | IN-DCL116 | ALT / TEMP / OIL DECAL |
| 14 | 1 | IN-DCL117 | FUEL FILTER DECAL |
| 15 | 1 | IN-DCL118 | HYDRAULIC FILTER DECAL |
| 16 | 2 | IN-DCL120 | YELLOW MAGNUM DECAL |
| 17 | 1 | IN-DCL121 | LIGHTS DECAL (WITH LIGHT KIT OPTION ONLY) |
| 18 | 1 | IN-DCL122 | PARKING BRAKE DECAL |
| 19 | 1 | IN-DCL123 | KEEP GAUGES IN PLACE DECAL |
| 20 | 1 | IN-DCL124 | AIR FILTER DECAL |
| 21 | 1 | IN-DCL125 | FAN CUTTING FINGERS/HAND DECAL |
| 22 | 2 | IND-DCL100 | M4226D MODEL NUMBER DECAL |
| | 2 | 48IND-DCL100 | M4826D MODEL NUMBER DECAL (48" MODEL ONLY) |
| 23 | 1 | IND-DCL200 | ULTRA LOW SULFUR DIESEL DECAL |
| 24 | 1 | STKE | HYDRAULIC WARM UP DECAL |
| 25 | 1 | STKG | BUCYRUS EQUIPMENT CO., INC. DECAL |
| 26 | 2 | STKZ | MAGNUM STRIPE DECAL |



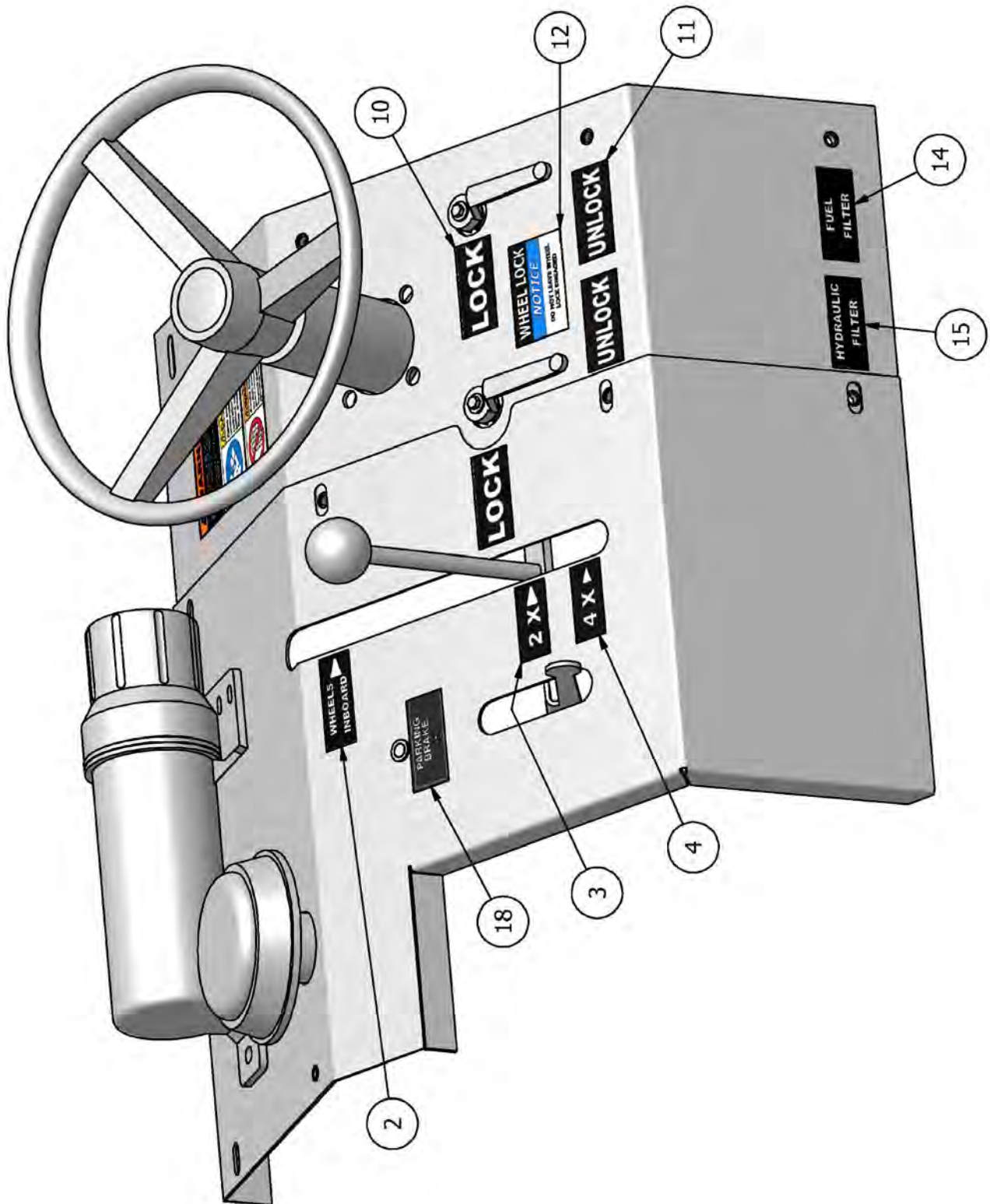

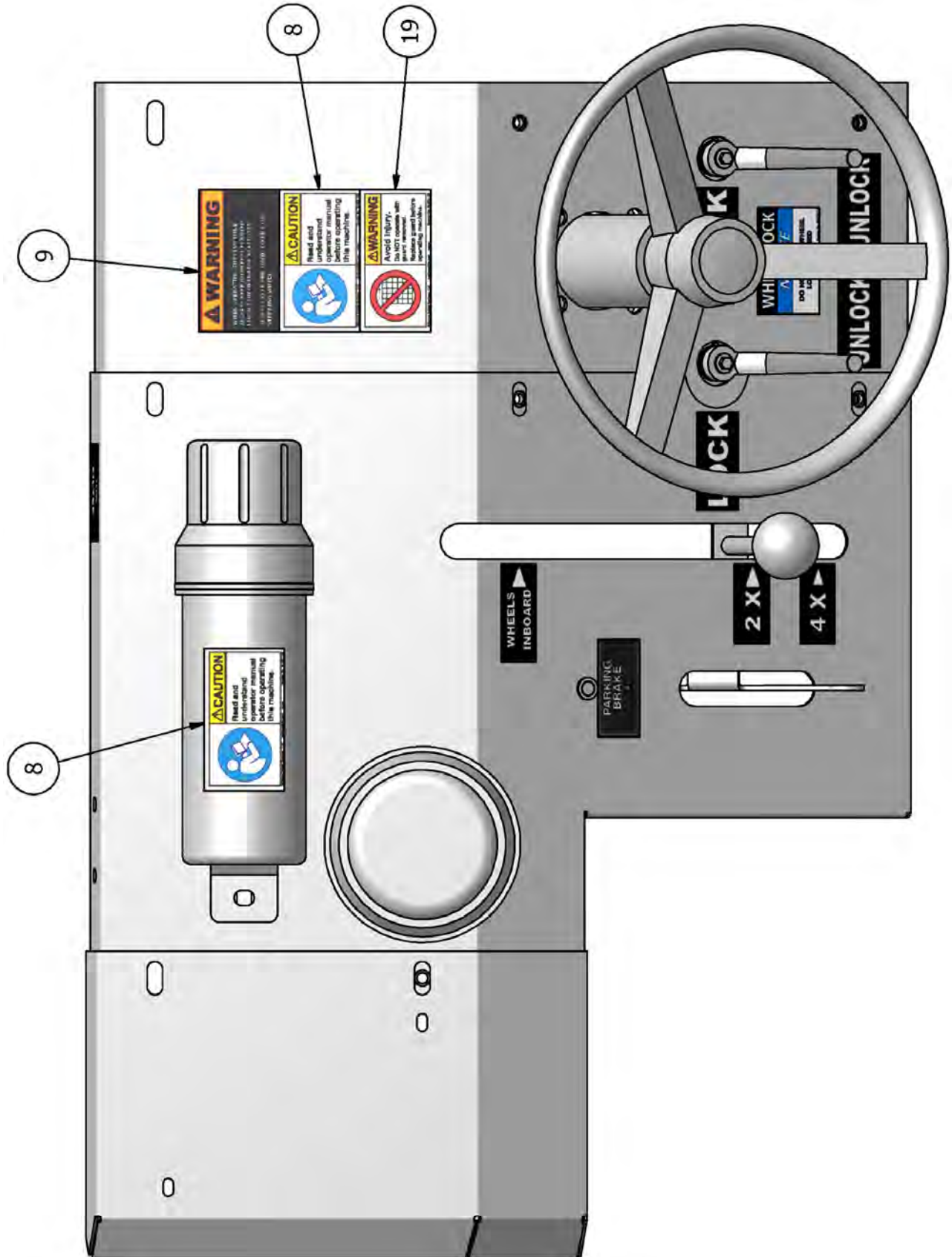

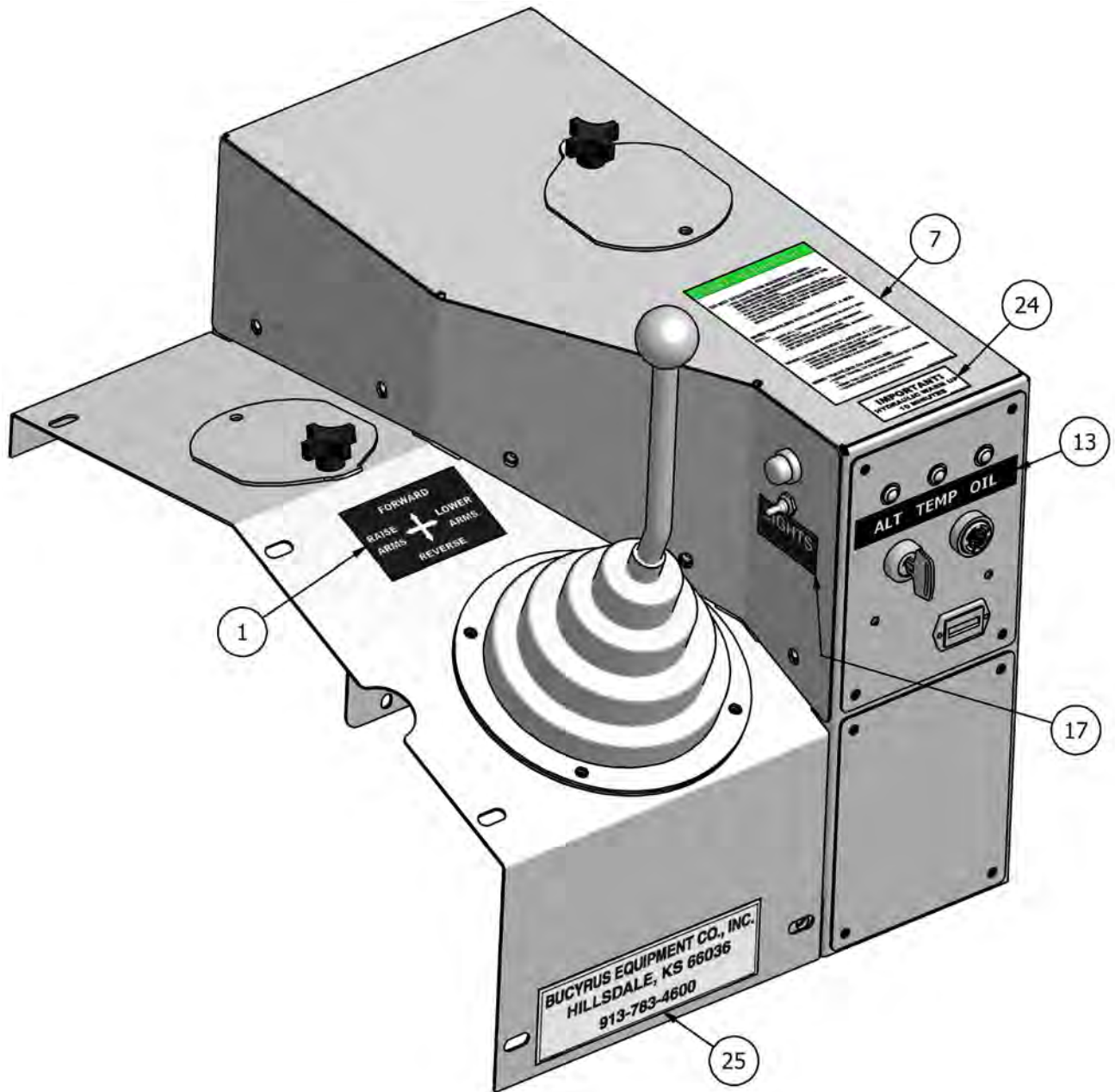

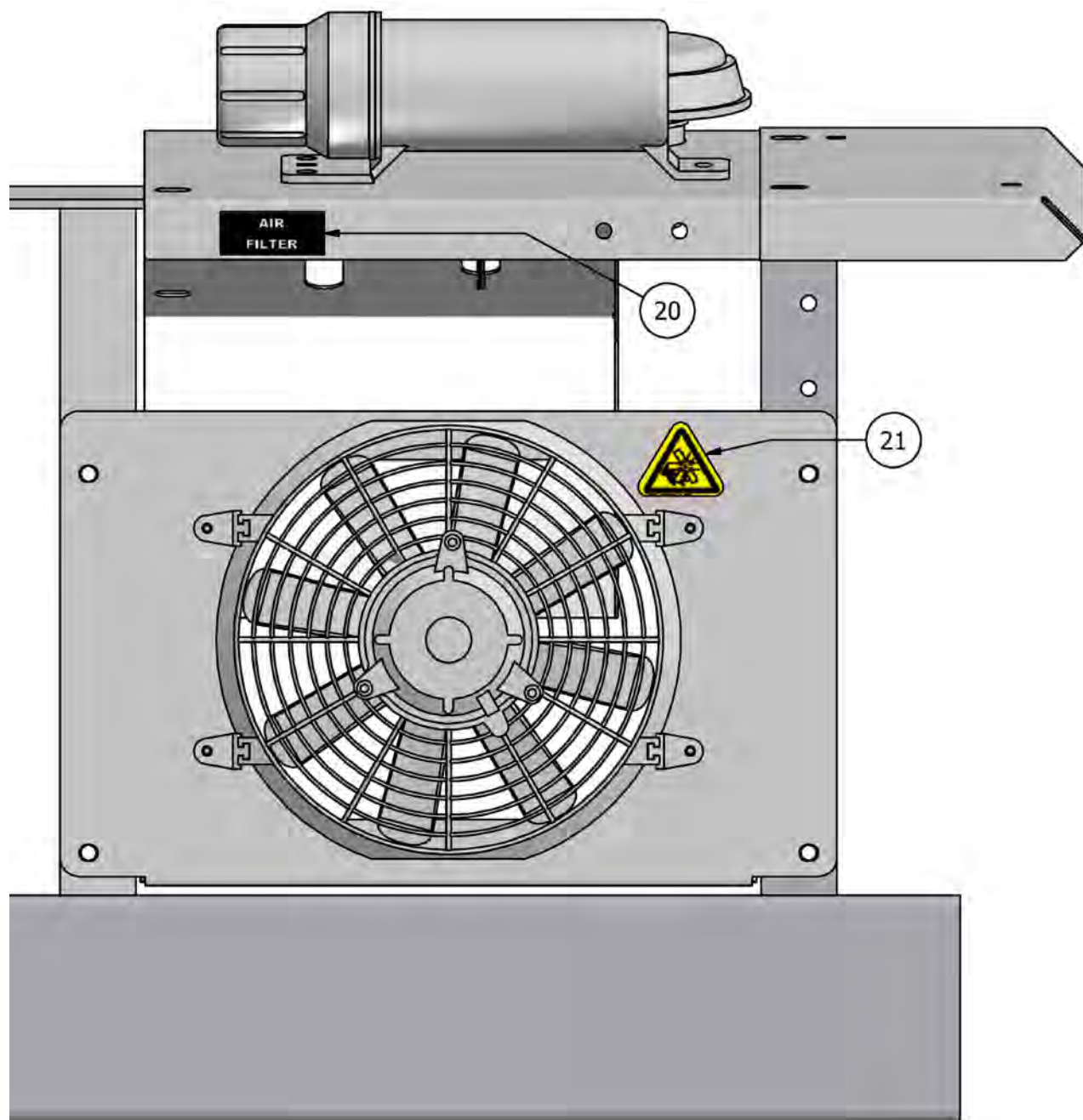

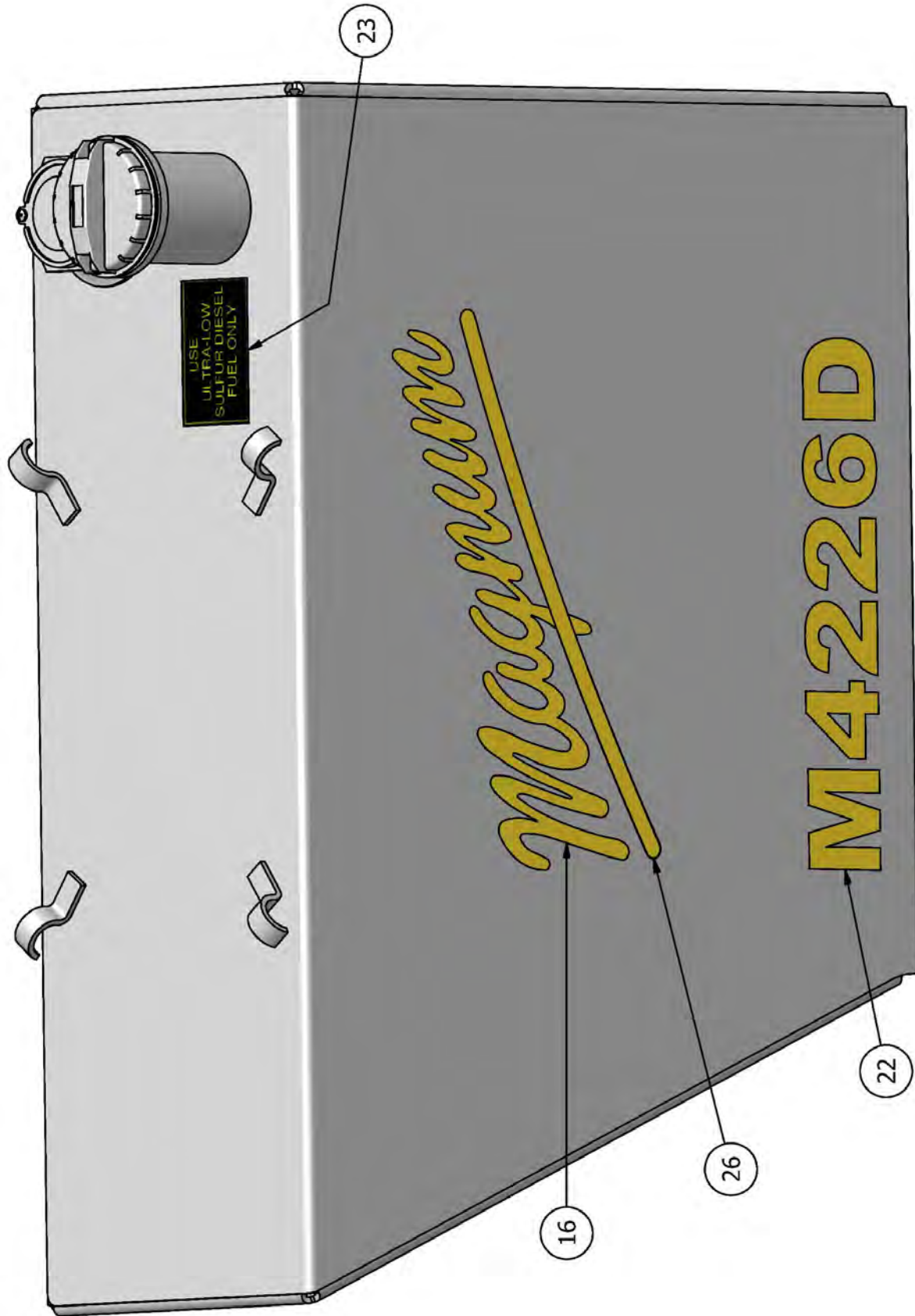

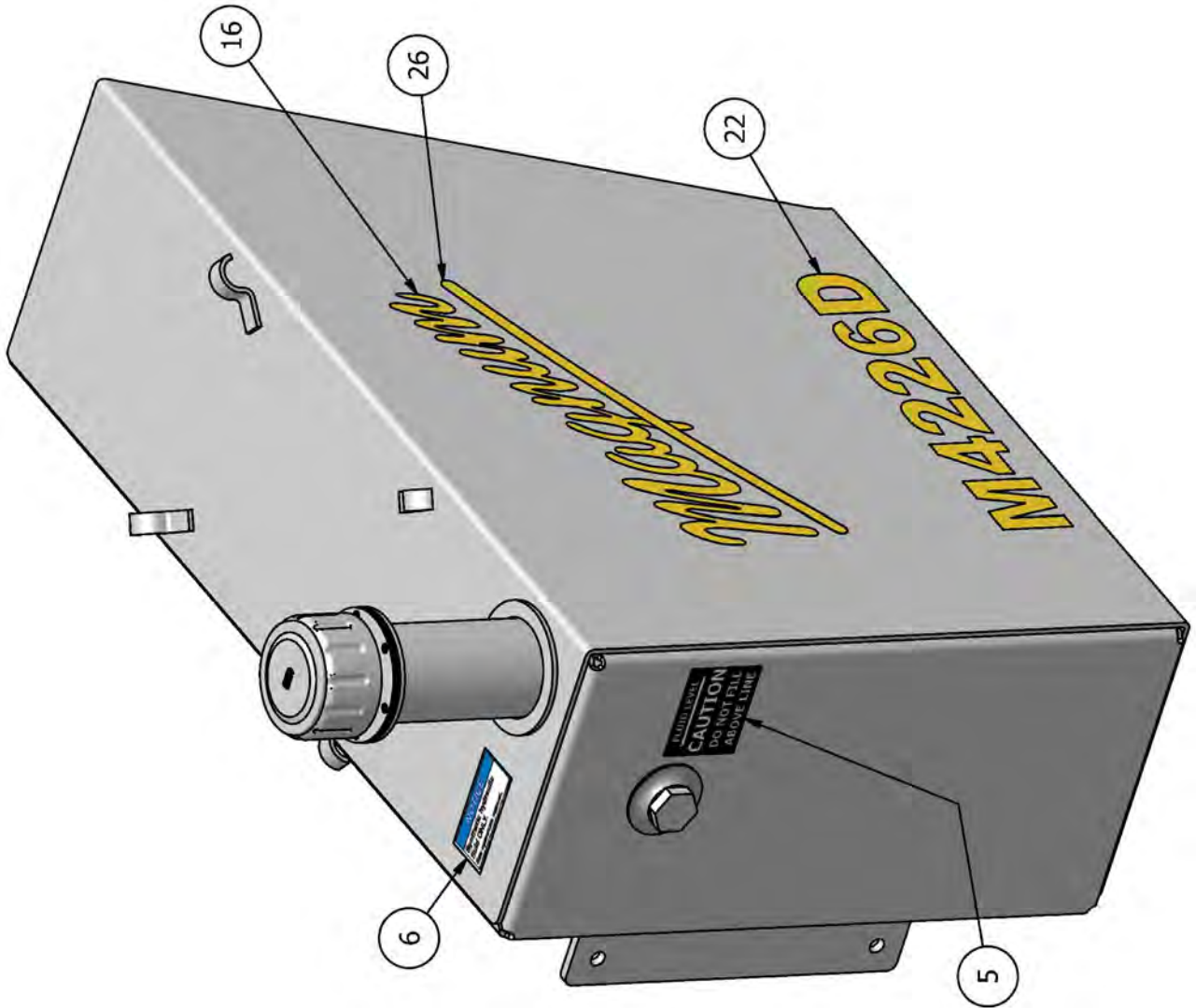

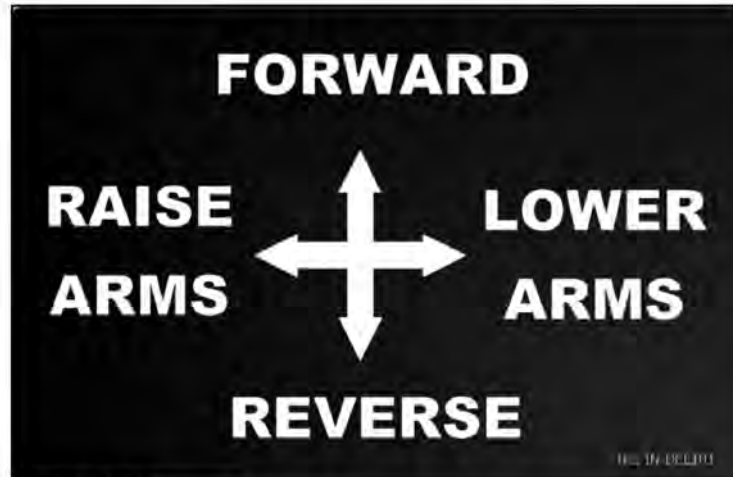

IN-DCL101



IN-DCL102



IN-DCL103



IN-DCL104



IN-DCL105



IN-DCL107

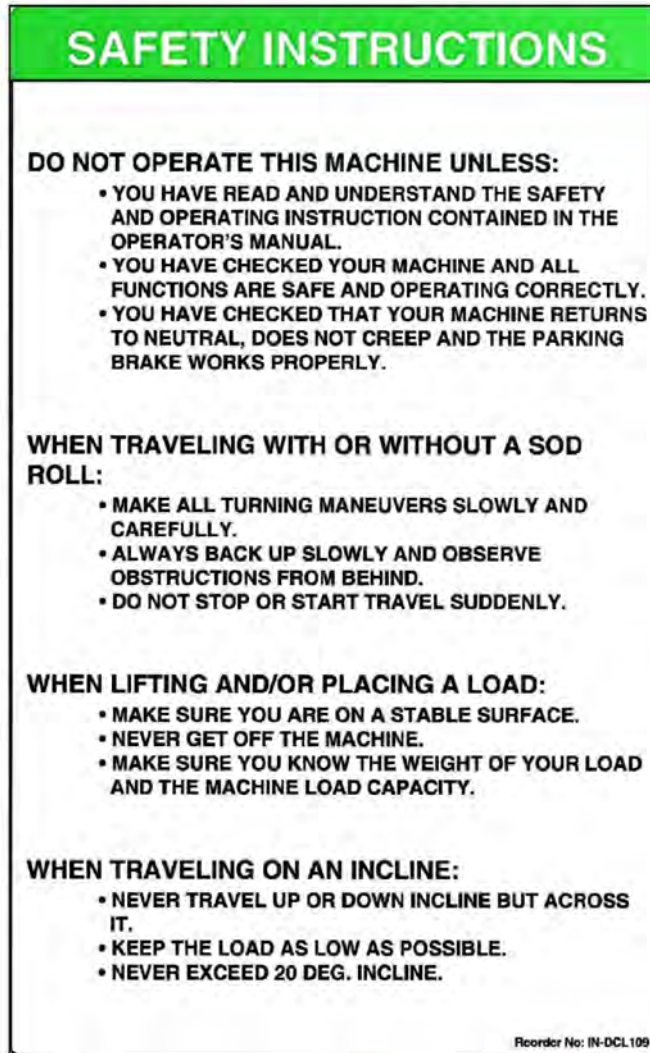

IN-DCL109



IN-DCL110



IN-DCL111



IN-DCL113



IN-DCL114



IN-DCL115



IN-DCL116



IN-DCL117



IN-DCL118



IN-DCL121



IN-DCL122



IN-DCL123

**AIR
FILTER**

IN-DCL124

**USE
ULTRA-LOW
SULFUR DIESEL
FUEL ONLY**

IND-DCL200

**IMPORTANT!
HYDRAULIC WARM UP
10 MINUTES**

Reorder No. STKE

STKE

**BUCYRUS EQUIPMENT CO., INC.
HILLSDALE, KS 66036
913-783-4600**

©Clarion Safety Systems, LLC clarionsafety.com

Reorder No. STKG

STKG



IN-DCL125

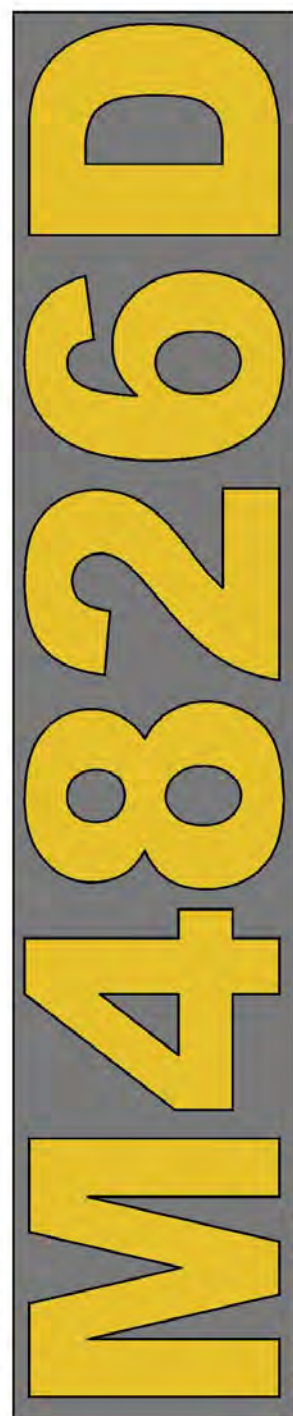
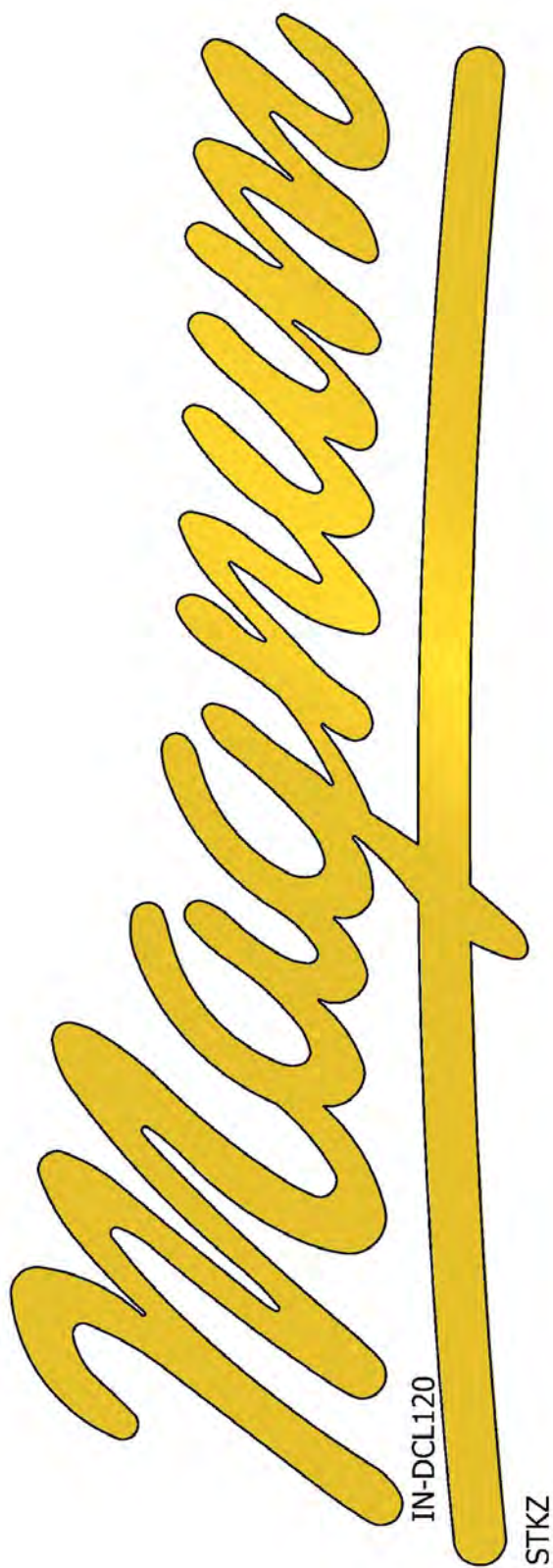

DECALS

NOTES:

[illegible]